

# MS55210S

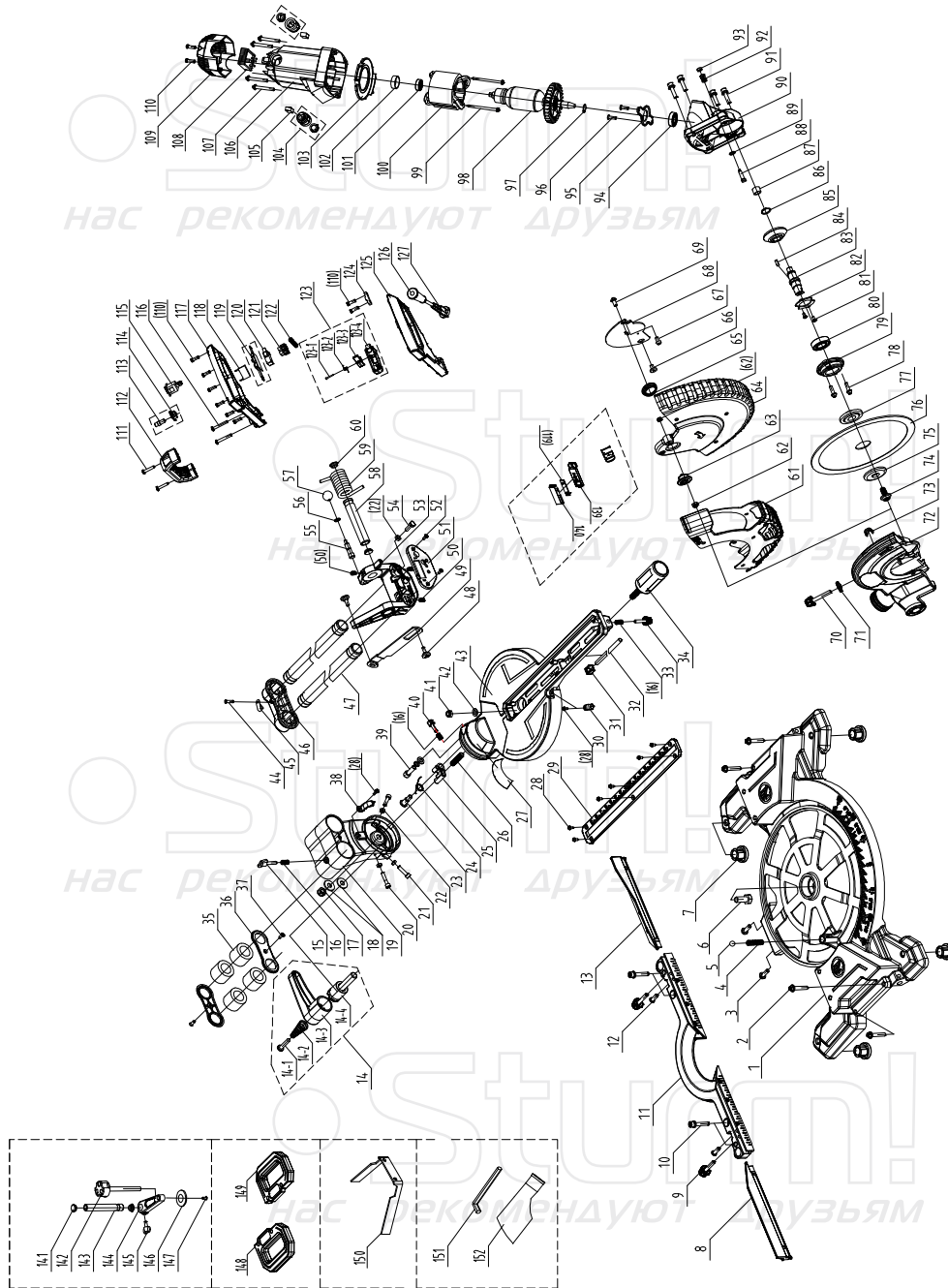

NO.	DESCRIPTION	NO.	DESCRIPTION	NO.	DESCRIPTION
1	BASE	52	CROSS RECESSED COUNTERSUNK HEAD SCREW M4*10	105	CARBON BRUSH
2	CROSS PAN HEAD THREE COMBINATION M5*30	53	BRACKET	106	CASING
3	CROSS PAN HEAD THREE COMBINATION M5*16	54	DISC POSITIONING SPRING	107	CROSS PAN HEAD SCREW TRIPLE COMBINATION M5*40
4	STEEL BALL Ø8	55	SELF LOCKING PIN	108	SPEED REGULATION MODULE
5	HEXAGON HEADED BOLT M8*20	56	O-RING 8*1.5	109	CASING REAR COVER
6	PLUM BLOSSOM RUBBER FOOT	57	BALL NUT	110	CROSS PAN HEAD TAPPING SCREW ST4.2*16
7	LEFT MOVABLE SUPPORT	58	CONNECTING SHAFT	111	CROSS PAN HEAD TAPPING SCREW ST4.8*25
8	SMALL KNOB 6*28	59	LARGE TORSION SPRING	112	HANDLE
9	HEXAGON SOCKET HEAD SCREW TRIPLE COMBINATION M6*30	60	CONNECTING SHAFT COVER	113	EJECTOR ROD
10	POSITIONING FRAME	61	TRANSPARENT COAT	114	EJECTOR SEAT
11	CROSS PAN HEAD SCREW M6X16	62	TYPE 2 NON-METALLIC HEXAGON LOCK NUT M5	115	GOVERNOR SWITCH
12	RIGHT MOVABLE SUPPORT	63	TRANSPARENT COVER PRESSING PLATE	116	CROSS PAN HEAD TAPPING SCREW ST4.8X35
13	REAR LOCKING HANDWHEEL ASSEMBLY	64	TRANSPARENT COVER	117	UPPER HANDLE
14	CROSS PAN HEAD TAPPING SCREW ST4.8X25	65	TRANSPARENT COVER TORSION SPRING	118	CAPACITANCE 0.22MF
14-1	CHAMFERED HANDWHEEL SPRING	66	INNER TRIANGULAR SCREW 10 CAR 6 x 7 LARGE FLAT HEAD	119	CIRCUIT BOARD
14-2	REAR LOCKING WRENCH	67	CROSS RECESSED PAN HEAD SCREW M6*10	120	MICROSWITCH
14-3	REAR LOCKING INSERT	68	LARGE COVER	121	WIRING BLOCK (2 ROWS)
14-4	BUTTERFLY SCREW M6*30	69	CROSS PAN HEAD SCREW M5*10	122	SWITCH TRIGGER SPRING
15	PULL ROD LOCKING SPRING	70	SMALL KNOB M6*40	123	TRIGGER AS-SWITCH
16	TYPE 2 NON-METALLIC HEXAGON LOCK NUT M10	71	KNURLED THIN NUT M6	123-1	SEMICIRCULAR HEAD RIVET 2 * 18
17	SHIM Ø10*Ø25*2	72	SKULL	123-2	SELF LOCKING TORSION SPRING
18	CONNECTING SEAT	73	PLASTIC THREAD BUCKLE	123-3	SELF LOCKING PIECE
19	HEXAGON SOCKET HEAD CAP SCREW M6*30	74	SAW BLADE FIXING SCREW (M8) x 20 LEFT-HANDED	123-4	SWITCH TRIGGER
20	HEXAGON SOCKET HEAD CAP SCREW M6*25	75	OUTER PRESSING PLATE	124	CRIMPING PLATE
21	NUT M6	76	SAW BLADE	125	LOWER HANDLE
22	ANGLE CONVERSION SCREW	77	INNER PRESSING PLATE	126	CABLE SHEATH
23	ANGLE CONVERSION TORSION SPRING	78	CROSS PAN HEAD SCREW TRIPLE COMBINATION M5*16	127	CABLE
24	ANGLE BLOCK	79	FRONT COVER		
25	HEXAGON SOCKET FLAT END SCREW M10 x 40	80	CROSS PAN HEAD SCREW TRIPLE COMBINATION M4X10		
26	CONNECTING BASE RULER	81	CROSS RECESSED COUNTERSUNK HEAD SCREW M4*10	139	LED PRESSING PLATE
27	CROSS PAN HEAD SCREW TRIPLE COMBINATION M4X10	82	BEARING PRESSING PLATE	140	LED TRANSPARENT SHEET
28	CUTTING PAVING	83	OUTPUT SHAFT		
29	DISC POINTER	84	FLAT KEY 4*12	141	FIXED ROD COVER
30	FRICITION BLOCK	85	BIG GEAR WHEEL	142	HANDWHEEL
31	DISC LOCKING ROD	86	SHAFT BEARING RETAINER 15	143	FIXED ROD
32	KNOB M6*18	87	NEEDLE ROLLER BEARING HK1010	144	CLAMPING BLOCK
33	SIDE HANDLE	88	GEAR LOCK PIN	145	BUTTERFLY SCREW M6X15
34	LINEAR BEARING Ø25*Ø40*35	89	O-RING	146	JAW IRON
35	LINEAR BEARING END CAP	90	GEAR BOX	147	NON STANDARD SCREW 6-CAR M5X7
36	CROSS RECESSED COUNTERSUNK HEAD SCREW M5*12	91	HEXAGON SOCKET HEAD CAP SCREW TRIPLE COMBINATION M6*25	148	LEFT WING GUARD
37	MITER POINTER	92	BUTTON SPRING	149	RIGHT WING GUARD
38	HEXAGON SOCKET CYLINDER HEAD THREE COMBINATION M8 * 25	93	GEAR LOCK PIN CAP	150	ANTI OVERTURNING SUPPORT
39	ANGLE CONVERSION EJECTOR ROD	94	ROLLING BEARING 6001Z3		
40	ANGLE CONVERSION EJECTOR ROD TYPE 2 NON-METALLIC HEXAGON LOCK NUT M8	95	BEARING PRESSING PLATE	151	INNER HEXAGON SPANNER
41	FLAT PAD 8 (Ø SIXTEEN x 1.2)	96	CROSS RECESSED COUNTERSUNK HEAD SCREW M5*18	152	DUST BAG
42	DISK				
43	CROSS PAN HEAD TAPPING SCREW ST4.2*10	97	SHAFT BEARING RETAINER 12		
44	THREAD BUCKLE	98	ROTOR		
45	PULL ROD REAR COVER	99	CROSS PAN HEAD TAPPING SCREW ST4.2*65		
46	PULL ROD	100	STATOR		
47	LARGE PAN HEAD SCREW M5*16	101	ROLLING BEARING 608Z3		
48	CONNECTING ROD	102	608 BEARING SLEEVE		
49	HEXAGON SOCKET FLAT END SCREW M6*8	103	WIND SHIELD		
50	LED LAMP HOLDER	104	BRUSH HOLDER ASSEMBLY		